

Model: DSS-PMT-100-520-200-XX

The Digi Spectronyx Systems RF Power Meter is a broadband, high-power RF measurement solution engineered for precise and reliable monitoring of RF signals across the 100 MHz to 520 MHz frequency range. Designed for laboratory, production, communication, and field-testing applications, the system supports continuous wave (CW) power measurements up to 250 W, making it suitable for both low-power verification and high-power transmitter testing.

Key Features

- 100 MHz – 520 MHz broadband frequency range
- Continuous Wave (CW) power handling up to 250 W
- High measurement accuracy and excellent linearity
- Low insertion loss for minimal signal degradation
- 50 Ohm impedance with low VSWR
- Rugged aluminum enclosure for industrial environments
- N-Type connector interface

Specifications

Parameter	Specification
Frequency Range	100 MHz – 520 MHz
Power Handling	250 W (CW)
Impedance	50 Ohm
VSWR	<1.2:1
Insertion Loss	≤0.25 dB
Accuracy	±5%
Operating Temperature	-55°C to +75°C
Storage Temperature	-60°C to +85°C

Applications

- RF Transmitter Testing
- Antenna Testing
- EMC Measurements
- Production Testing
- Communication System Verification

Interface Features

- TCP/IP - SNMP and Browser Interface via Local Area Network
- User ID and Password Protected Access and Control
- Multiple Units Can Be Networked and Simultaneously Monitored
- On-Site or Remote Monitoring Support

Connector Configurations

Model	RF IN	RF OUT
DSS_PMT_100_520_200_11	N Female	N Female
DSS_PMT_100_520_200_12	N Female	N Male
DSS_PMT_100_520_200_22	N Male	N Male

Digi Spectronyx

MECHANICAL DRAWING for (DSS_PMT_100_520_200_11)

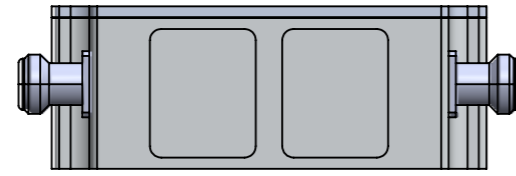

BOTTOM VIEW

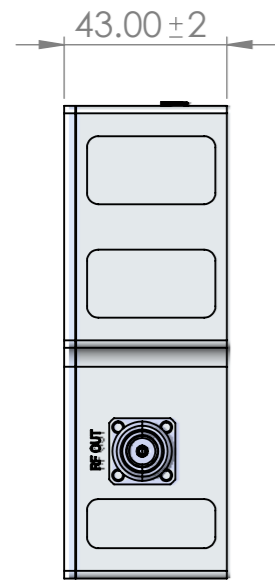

RH VIEW

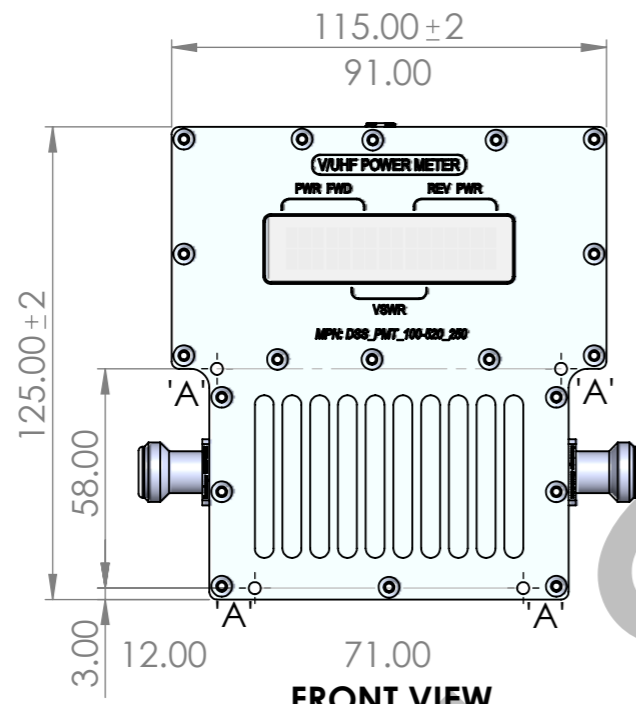

FRONT VIEW

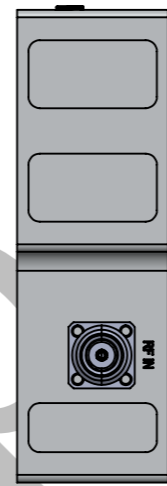

LH VIEW

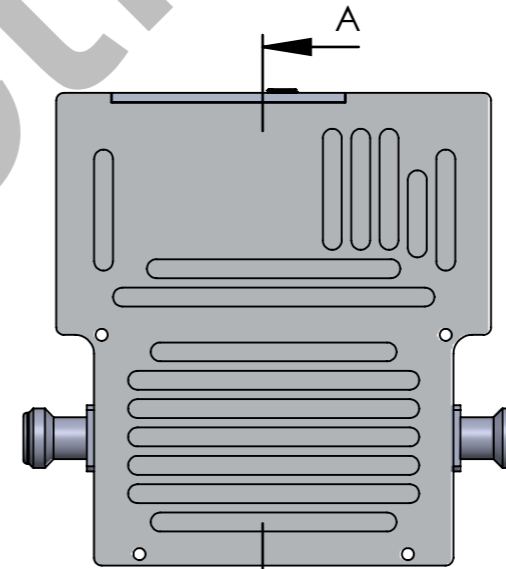

REAR VIEW

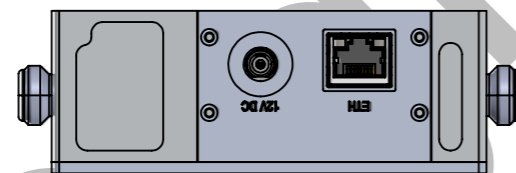

TOP VIEW

4x \varnothing 3.20 THRU AT 'A'
PLACES FOR
MOUNTING